

- Non intrusive
- Active sensor
- Alignment Compensation
- Compact design 30mm

- M16x1,5 mount
- Maximal service temperature: 200°C

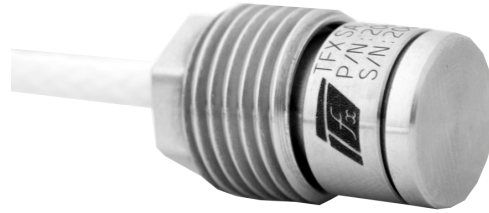

DESCRIPTION

The Tfx-206 conductive heat flux sensors are particularly sensitive thanks to their large measurement surface. They are designed to be placed inside the tooling, non-intrusively, at 1mm of the cavity. Their small size makes them compatible with halves mould having a thickness of at least 35mm.

They are recommended for monitoring processes such as liquid resin infusion and RTM. The active component make them sensitive to the front of resin, even in isothermal injections.

PRODUCT NUMBER

Product 206. [] [] [] . 25 . [] [] []

Material	Stainless Steel	R	E Standard (TC T)	Cable type
	Aluminium	A		
Signals	Flux and temperature	S	M Active sensor (TC J or T)	Cable length
	Flux, temperature and heating command	A	010 1m	
TC type	Thermocouple J	J	On demand, in dm	
	Thermocouple K	K	A None	Plug
	Thermocouple T	T	F LEMO 3p female screwable	
Dimension Height		25	H LEMO 7p female screwable	

Standard reference : 206.AAT.25.H010M

THERMAL SPECIFICATIONS

Name	Description	Min	Typ	Max	Units
T _{nom}	Service temperature			200	°C
φ _{noise}	Thermal noise (peak to peak)		2		W/m ²

ELECTRICAL SPECIFICATIONS

FLUX

Name	Description	Min	Typ	Max	Units
R _{in}	Differential input impedance		50		Ω
Sensi	Typical sensitivity		60		nV/W/m ²

THERMOCOUPLE

Name	Description	Min	Typ	Max	Units
Type	Thermocouple junction type		T		

ACTIVE

Name	Description	Min	Typ	Max	Units
R	Impedance		2700		Ω
V _{nom}	Nominal Voltage		24		V

PINS ASSIGNMENT

F PLUG (PASSIVE VERSION)

E Cable

Pin	Colour	Name	Description
1	Red	F	Negative differential Flux Input
2	Brown	+	Positive differential Common Input
3	White	T	Negative differential Thermocouple Input
		Ground	Grounded Shielding

A AND H PLUG

F cable

Pin	Colour	Name	Description
1	Black	Heat	Heating command
2	Green	F+	Positive differential Flux Input
3	Brown	T+	Positive differential Thermocouple Input
4	White	T-	Negative differential Thermocouple Input
5	Violet	F-	Negative differential Flux Input
6	Red	Vcc	Heating power supply

M cable

Pin	Colour	Name	Description
1	Yellow	Heat	Heating command
2	Blue	F+	Positive differential Flux Input
3	Brown:T Black: J	T+	Positive differential Thermocouple Input
4	White	T-	Negative differential Thermocouple Input
5	Red	F-	Negative differential Flux Input
6	Green	Vcc	Heating power supply
7	nc		
		Ground	Grounded Shielding

DIMENSIONS

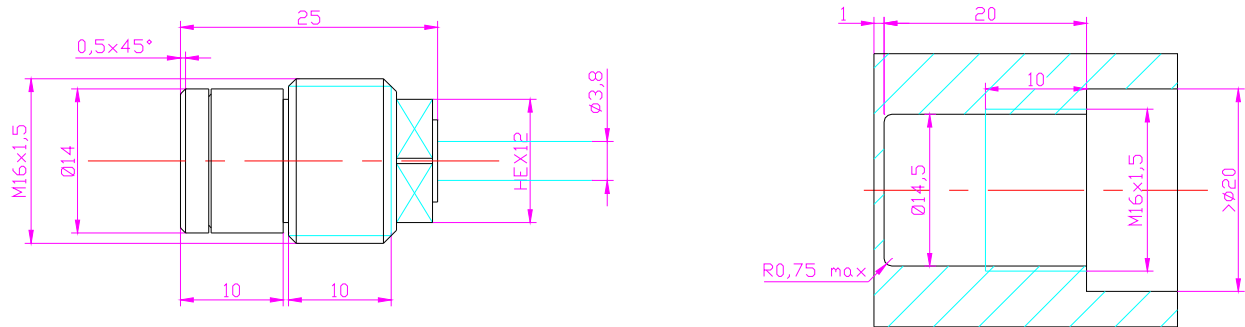

CONTENT

- 1 sensor

TFX SA reserves the right to change the circuitry and specifications without notice at any time.